



PYRAMIS
Kitchen Inspirations



>athena series





EASYFIX™



PYRAMIS
Kitchen Inspirations

>ATHENA (62x50) 1B 1D

>Sink Dimensions
620 x 500mm

>Bowl Dimensions
340 x 400 x 180mm

>Minimum Base Unit
45cm

>Bowl Overflow

>Proposed Accessories



Wooden Chopping Board



Satin



Polished



Linen

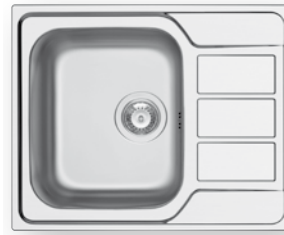

Reversible



Inset



Ø92mm

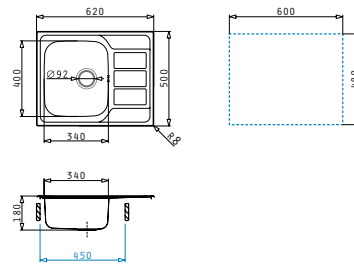

>ATHENA EXTRA (62x50) 1 ½B 1D

>Sink Dimensions
620 x 500mm

>Bowl Dimensions
340 x 400 x 180mm / 165 x 290 x 120mm

>Minimum Base Unit
60cm

>Bowl Overflow

>Proposed Accessories



Wooden Chopping Board



Transparent Colander



Inox Colander



Polished



Linen



Reversible



Inset



Ø92mm

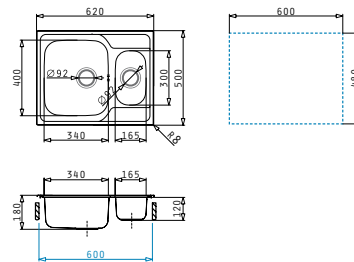

>ATHENA (79x50) 1B 1D

>Sink Dimensions
790 x 500mm

>Bowl Dimensions
340 x 400 x 180mm

>Minimum Base Unit
45cm

>Bowl Overflow

>Proposed Accessories



Wooden Chopping Board



Satin



Polished



Linen



Reversible



Inset



Ø92mm

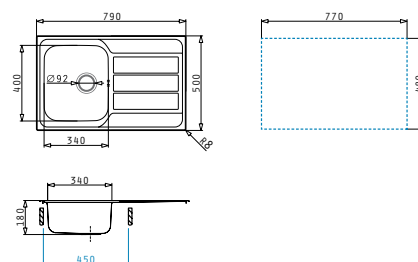

>ATHENA EXTRA (79x50) 1 ½B 1D

>Sink Dimensions
790 x 500mm

>Bowl Dimensions
340 x 400 x 180mm / 165 x 290 x 120mm

>Minimum Base Unit
60cm

>Bowl Overflow

>Proposed Accessories



Wooden Chopping Board



Transparent Colander



Inox Colander

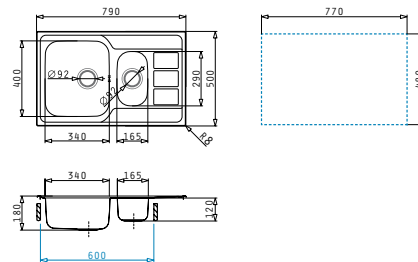

>ATHENA (79x50) 2B

>Sink Dimensions
790 x 500mm

>Bowl Dimensions
340 x 400 x 165mm / 340 x 400 x 165mm

>Minimum Base Unit
80cm

>Bowl Overflow

>Proposed Accessories



Wooden Chopping Board



Inox Basket

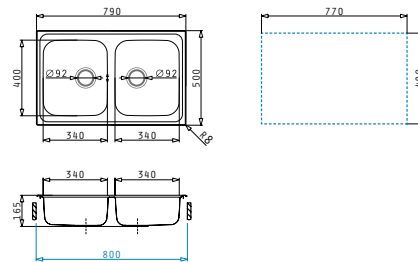
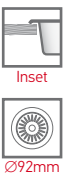

>ATHENA (86x50) 1B 1D

>Sink Dimensions
860 x 500mm

>Bowl Dimensions
340 x 400 x 180mm

>Minimum Base Unit
45cm

>Bowl Overflow

>Proposed Accessories



Wooden Chopping Board

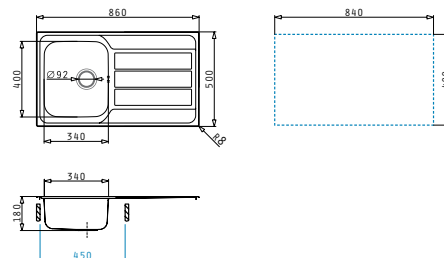
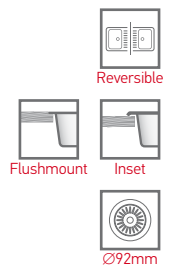

>ATHENA (86x50) 1 ¼B 1D

>Sink Dimensions
860 x 500mm

>Bowl Dimensions
340 x 400 x 180mm / 75 x 270 x 20mm

>Minimum Base Unit
50cm

>Drainer Overflow

>Proposed Accessories



Wooden Chopping Board



Inox Colander

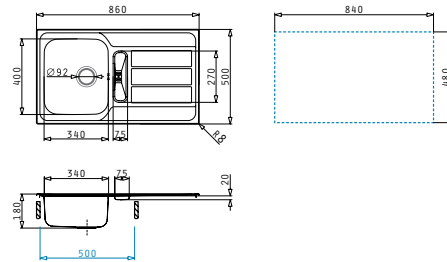
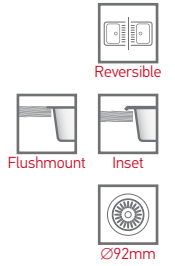
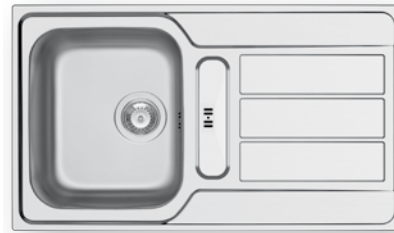

>ATHENA (86x50) 2B

>Sink Dimensions
860 x 500mm

>Bowl Dimensions
340 x 400 x 180mm / 340 x 400 x 180mm

>Minimum Base Unit
80cm

>Bowl Overflow

>Proposed Accessories



Wooden Chopping Board



Inox Basket

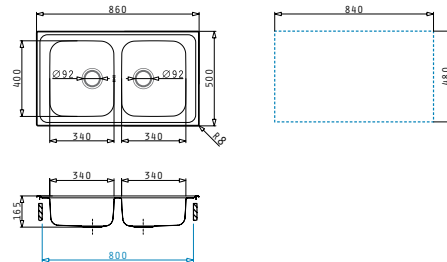

>ATHENA (100x50) 1 ½B 1D

>Sink Dimensions
1000 x 500mm

>Bowl Dimensions
340 x 400 x 165mm / 170 x 275 x 90mm

>Minimum Base Unit
60cm

>Bowl Overflow

>Proposed Accessories



Wooden Chopping Board



Inox Colander

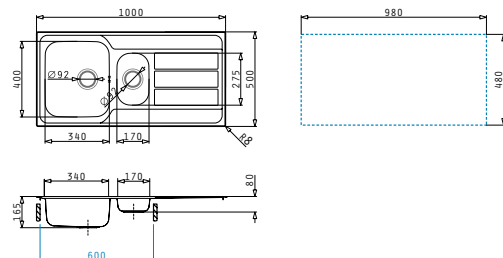
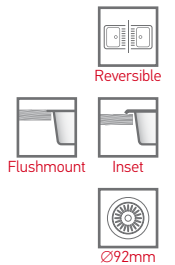

>ATHENA EXTRA (100x50) 1 ½B 1D

>Sink Dimensions
1000 x 500mm

>Bowl Dimensions
340 x 400 x 180mm / 165 x 290 x 120mm

>Minimum Base Unit
60cm

>Bowl Overflow

>Proposed Accessories



Wooden Chopping Board



Transparent Colander



Inox Colander

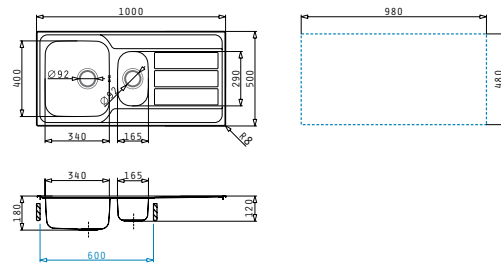
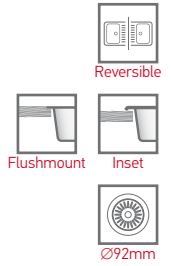
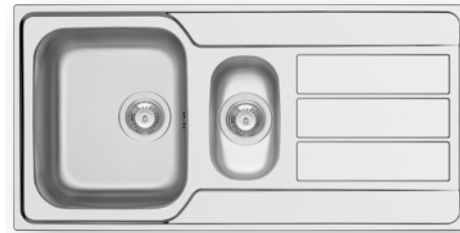

>ATHENA (116x50) 2B 1D

>ATHENA EXTRA (116x50) 2B 1D

>Sink Dimensions
1160 x 500mm

>Bowl Dimensions
340 x 400 x 165mm / 340 x 400 x 165mm
340 x 400 x 190mm / 340 x 400 x 190mm (ATHENA EXTRA)

>Minimum Base Unit
80cm

>Bowl Overflow

>Proposed Accessories



Wooden Chopping Board



Inox Basket

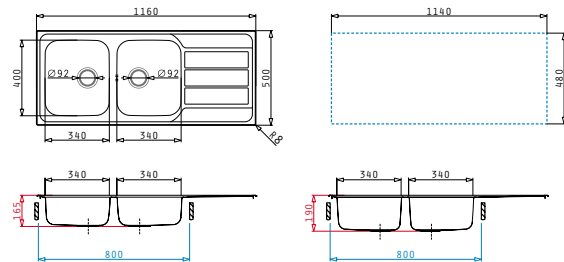

ATHENA (116X50) 2B 1D

ATHENA EXTRA (116X50) 2B 1D



PYRAMIS uses traditionally, the best quality performance Stainless Steel material AISI 304. This type of stainless steel contains a significant amount of chromium, and sufficient nickel to "stabilise" the microstructure, that gives to these steel goods formability and ductility. The typical composition is 18% chromium and 10% nickel and this makes PYRAMIS' Stainless Steel Sinks extremely resistant to rust or corrosion in normal household conditions.



For even greater safety, the surface of Stainless Steel Sinks provides protection against bacteria and makes the sink perfectly healthy and suitable for food contact.



As proof of the exceptional quality materials, Stainless Steel Sinks carry a Lifetime Guarantee.



PYRAMIS Stainless Steel Sinks for inset installation are provided with a preinstalled sealant of polyurethane underneath the sink, thus, the installation of an inset sink becomes much easier and friendlier since, the sealant that is already installed provides time-saving compared to other sealing methods.



PYRAMIS

Kitchen Inspirations

PYRAMIS METALLOURGIA A.E.

17th km Thessaloniki-Serres
P.O. Box 10 278
54110, Thessaloniki
Greece

Tel.: +30 23940 56751
Fax.: +30 23940 56745

exportsales@pyramis.gr
www.pyramisgroup.com